

Quicklift Installation Instructions

www.ergomart.com | 888 420 3200

1

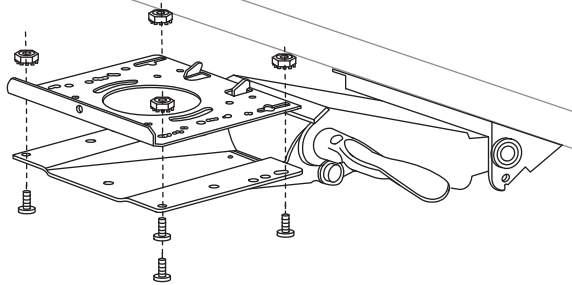

Using included hardware, attach one universal adapter plate to your keyboard arm.

2

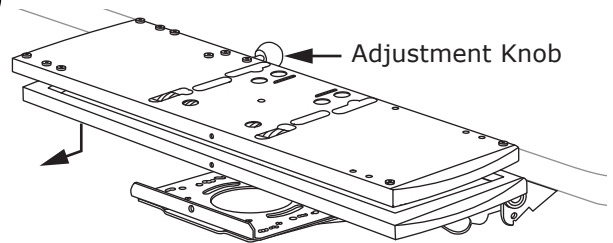

Place the Quicklift unit on the adapter plate, making sure to align the tabs in the adapter plate with the slots in the bottom of the Quicklift. The adjustment knob should be on the left side on the top.

3

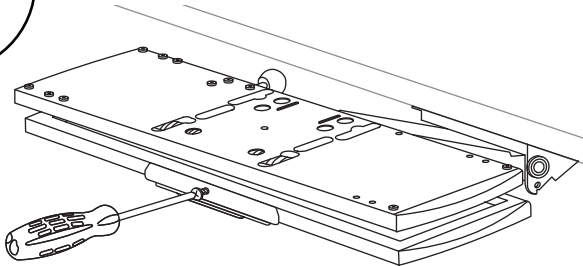

Slide the Quicklift forward on the adapter plate, locking it in place. Secure with a Phillips pan head screw.

4

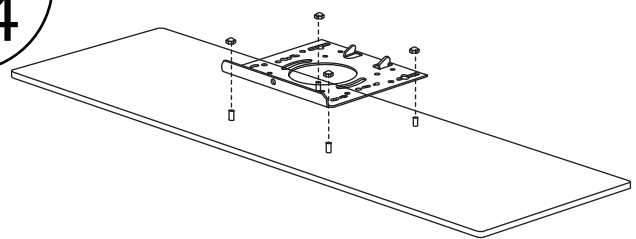

Using hardware that came with your keyboard tray (hardware not included with Quicklift) secure the 2nd universal adapter plate to your keyboard tray as shown.

5

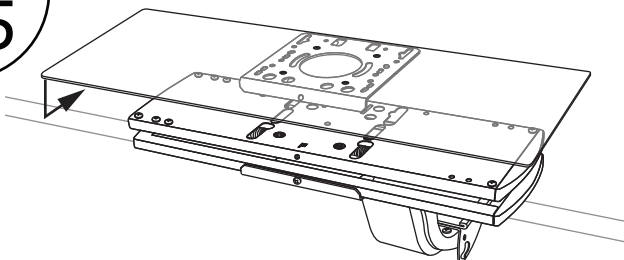

Place the tray and bracket on the Quicklift, making sure to align the tabs in the adapter plate with the slots in the top of the Quicklift.

6

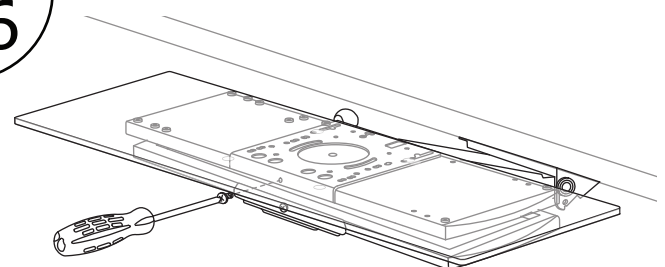

Slide the tray back on the Quicklift, locking it in place. Secure with a Phillips pan head screw.

7

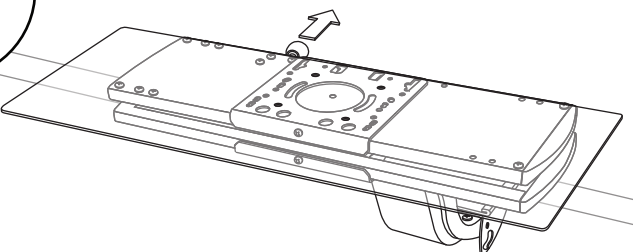

Once installed, pull the adjustment knob ALL THE WAY OUT toward the table (completely clearing the locking teeth) to adjust the platform height.

8

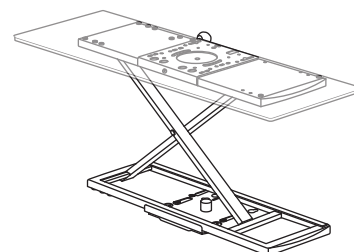

Once it is in the desired position, release the knob to lock platform in place. Adjusting the height with the knob only partially extended will damage locking teeth and impair functionality.

ERGOMART

Ergonomic solutions for office and light industrial work environments

©2017 Ergomart. All rights reserved.